

TOTALLY ENCLOSED SPRING SET MOTOR BRAKE

USED ON:

- Conveyors
- Packing Machinery
- Case Packing and Unpacking
- Wrapping Machinery
- Carton Filling Machines
- Paper Converting Machinery
- Automated Machinery

SPRING APPLIED/AIR RELEASE BRAKE

MODEL	WK ² OF ROTATING PARTS	TORQUE** (IN-LBF)	STATIC	DYNAMIC	MAXIMUM RPM 1800
625 AND 875 SPRING BRAKE	.44 IN ² -LBF	BRAKE @ 0 psi FULL LINING	300	250	
1125, 1375 SPRING BRAKE	11.2 IN ² -LBF		1200	1000	
1625 SPRING BRAKE	11.2 IN ² -LBF		1500	1250	

STANDARD ASSEMBLIES	I (INCHES)	O (INCHES)	SHAFT	OUTPUT SHAFT OHL*	NEMA FRAMES	HEAT DISSIPATION	HEAT CAPACITY	WEIGHT
625SB-CC 875SB-CC	.626 .876	.625 .875	2.125 2.125	0 0	48Y/56C 143TC/145TC	.12 HP	20,000 FT-LBF	14 LBS.
625SB-CS 875SB-CS	.626 .876	.875 .875	2.625 2.625	140 LBS 140 LBS	48Y/56C 143TC/145TC			
1125SB-CC 1375SB-CC 1625SB-CC	1.126 1.376 1.626	1.125 1.375 1.625	2.625 3.125 3.750	0 0 0	182TC/184TC 213TC/215TC 254TC	.30 HP	45,000 FT-LBF	56 LBS.

*Based on 10,000 hours bearing life with load 1 inch from bearing face.

**The initial torque on new units may be up to 40% less than torque values shown until the friction lining is worn in.

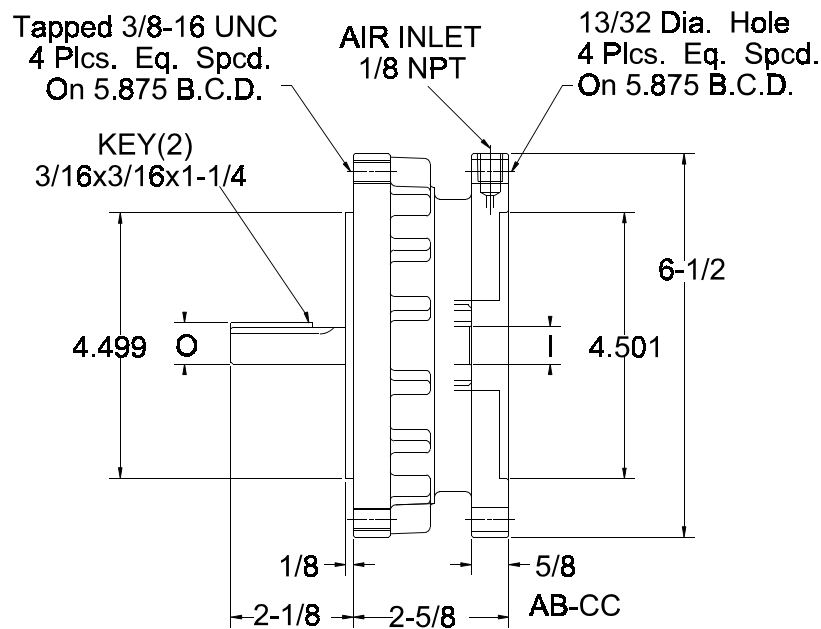

AIR APPLIED/SPRING RELEASED BRAKE

AB BRAKE

MODEL	WK ² OF ROTATING PARTS	TORQUE** (IN-LBF)	STATIC	DYNAMIC	MAXIMUM RPM 1800
625 AND 875 AIR BRAKE	.44 IN ² -LBF	BRAKE @ 80 psi FULL LINING	500	425	

STANDARD ASSEMBLIES	I (INCHES)	O (INCHES)	SHAFT	OUTPUT SHAFT OHL*	NEMA FRAMES	HEAT DISSIPATION	HEAT CAPACITY	WEIGHT
625AB-CC 875AB-CC	.626 .876	.625 .875	2.125 2.125	0 0	48Y/56C 143TC/145TC	.12 HP	20,000 FT-LBF	14 LBS.

*Based on 10,000 hours bearing life with load 1 inch from bearing face.

**The initial torque on new units may be up to 40% less than torque values shown until the friction lining is worn in.

THE CARLSON COMPANY INC. • 6045 North Broadway • Wichita, Kansas 67219 USA

Phone: 316 744 0481 • Fax: 316 744 2144 • E-mail: info@carlsoncompany.com

www.carlsoncompany.com